

PRONA

WATERPROOF LUMINAIRES

VIN07 6020A SG30

VIN07 6020A SG40

VIN07 6020A SG60

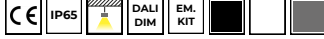
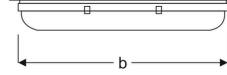
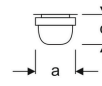

MECHANICAL SPECS / MEKANİK ÖZELLİKLER

Application Areas Uygulama Alanları	Warehouse - Parking areas - Loading areas - Industrial areas
Luminaire Type Ürün Tipi	Waterproof luminaires
Luminaire Body Ürün Gövdesi	Polycarbonate body
Luminaire Diffuser Ürün Difüzörü	Polycarbonate diffuser
Luminaire Colour Ürün Gövde Rengi	S : Ral 9005 Jet black / B : Ral 9016 Traffic White / G : Ral 9006 Grey
Ingress Protection (IP) Rating IP Sınıfı	IP65
Impact Resistance (IK) Rating IK Sınıfı	IK08

OPTICAL SPECS / OPTİK ÖZELLİKLER

Light Source Işık Kaynağı	Mid Power LED
CRI Value CRI Değeri	>80
UGR Value UGR Değeri	<21 (EN124664-1)
Photo Biological Class Fotobiyolojik Risk Grubu	Group-0 No Risk
Beam Angle Işık Açısı	120°
Driver (220-240V) Sürücü	Osram - Tridonic & ENEC Driver

ELECTRICAL SPECS / ELEKTRİKSEL ÖZELLİKLER

Mains Voltage Giriş Gerilimi	220-240 V
Mains Frequency Frekans	50/60 Hz
Protection Class Koruma Sınıfı	I
Led Service (25°C) Led Ömrü	L80=50.000h
Power Factor Güç Faktörü	>0,973
Operating Temperature Çalışma Sıcaklığı	-35°C & -55°C
Hot Wire Resistance Kablo Sıcaklık Direnci	650°C

OPTIONS / OPSİYONLAR

1 Hour Emergency Kit	3 Hour Emergency Kit	DALI	SENSOR
+	+	+	+

Product Code Ürün Kodu	Power (W) Watt	Lumen (lm) Işık Akısı	Efficacy (lm/W) Verimlilik	Col. Temp (K) Kelvin	Dimensions (mm) Boyutlar (a x b x c) Ø	Pack. Qty Koli Adedi	Pack. Weight (kg) Koli Ağırlığı
VIN07 6020A SG30	20	2000	100	3000	110x660x95	20	1,00
VIN07 6020A SG40	20	2000	100	4000	110x660x95	20	1,00
VIN07 6020A SG60	20	2000	100	6000	110x660x95	20	1,00